

GOOGLE WAFFLE/GOOGLE DRIVE

LUCIDPRESS TRANSITION

Starting August 20, the current Lucidpress app in Google Drive will not work. Never fear - all your documents are saved.

Step 1: Uninstall the Lucidpress app from Google Drive

To uninstall,

a. Navigate to the Google Admin Console

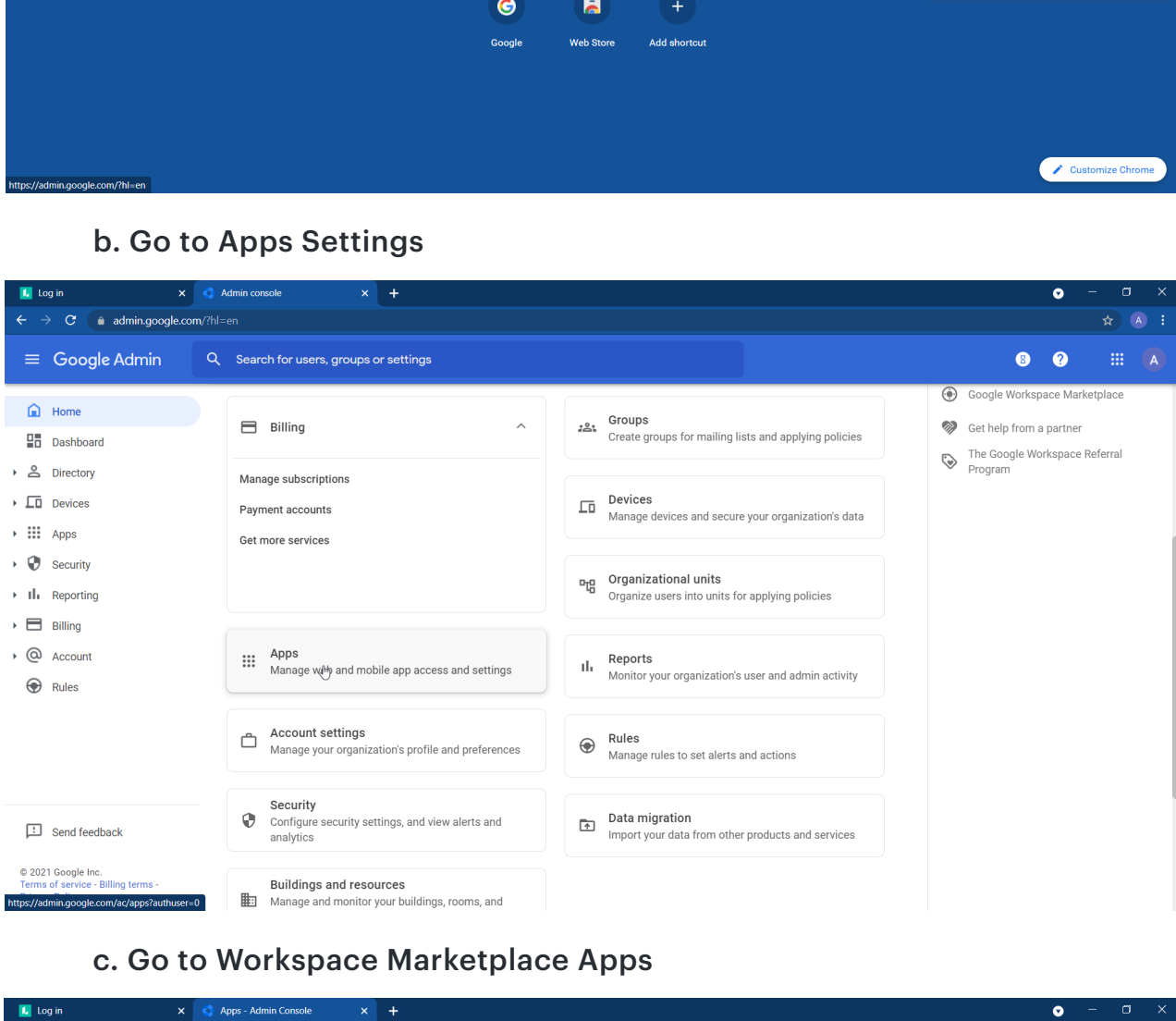

b. Go to Apps Settings

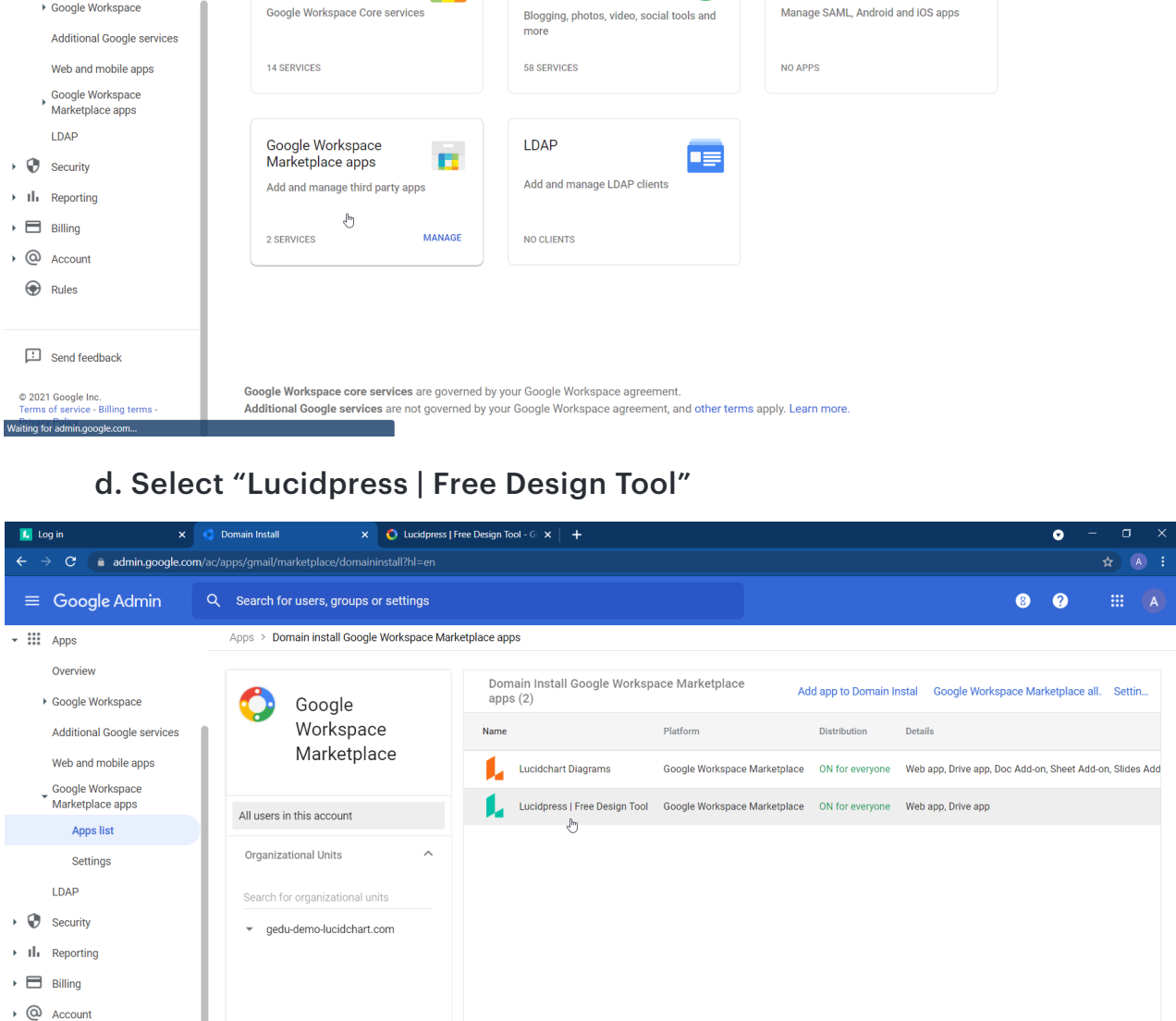

c. Go to Workspace Marketplace Apps

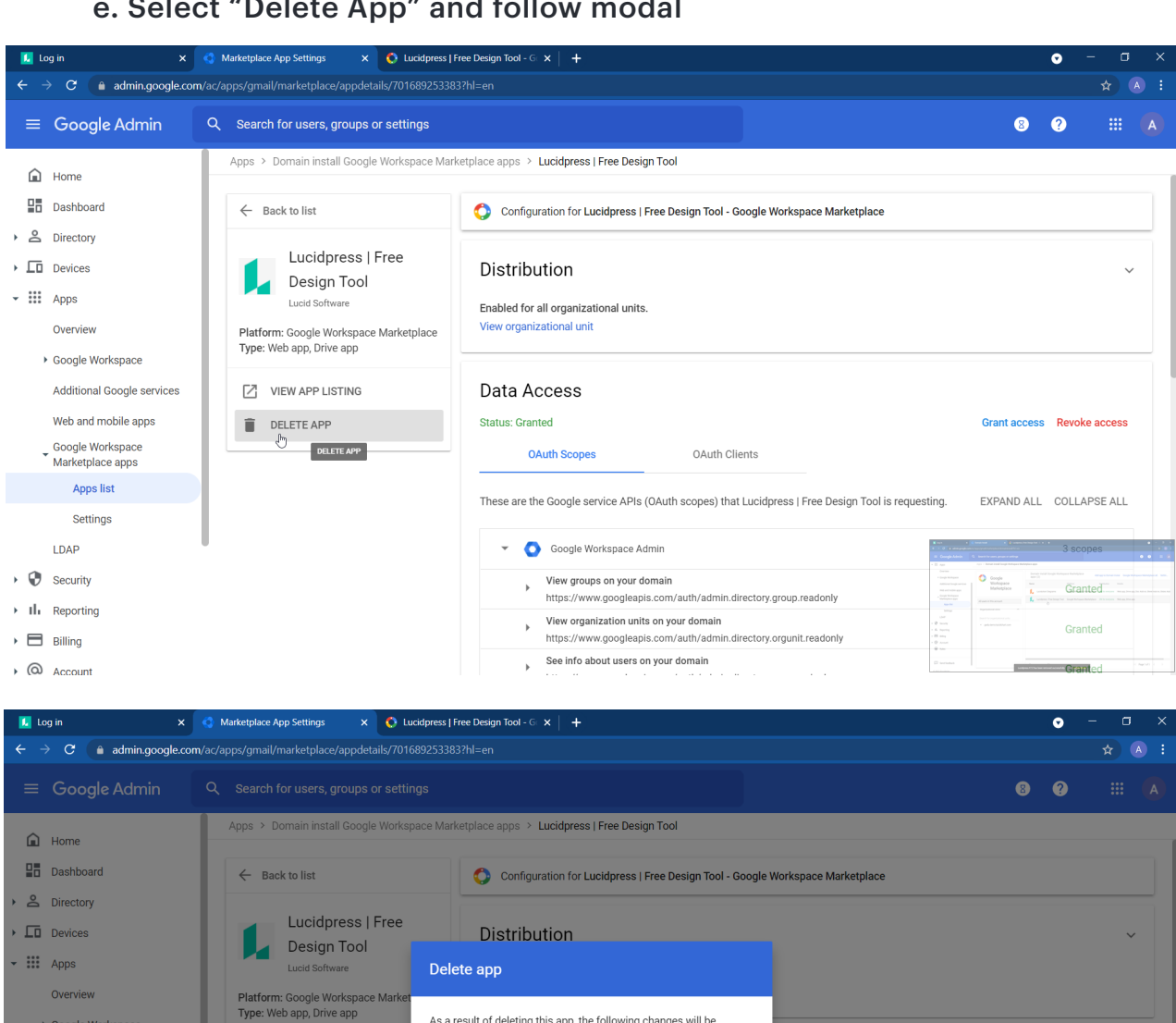

d. Select “Lucidpress | Free Design Tool”

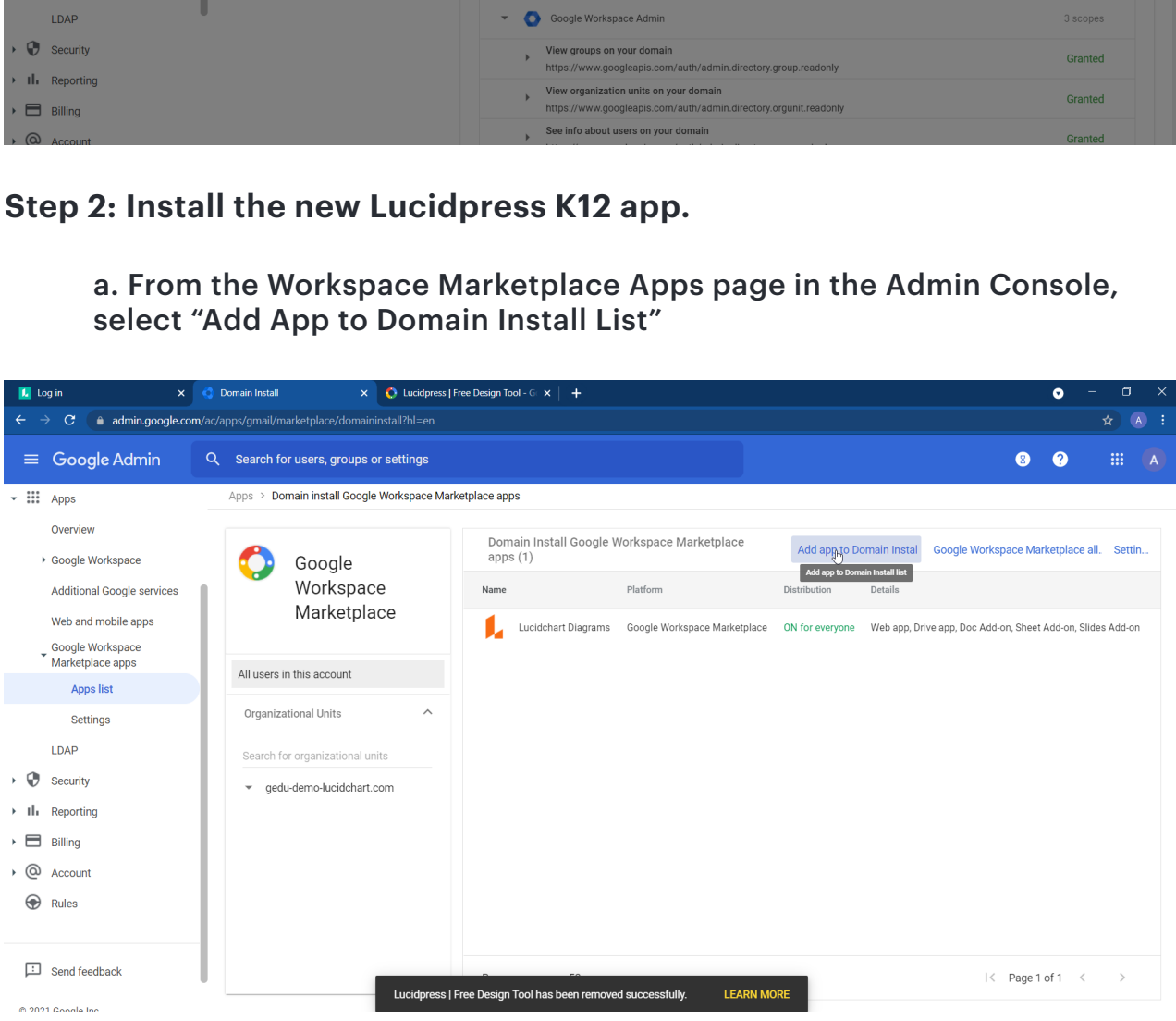

e. Select “Delete App” and follow modal

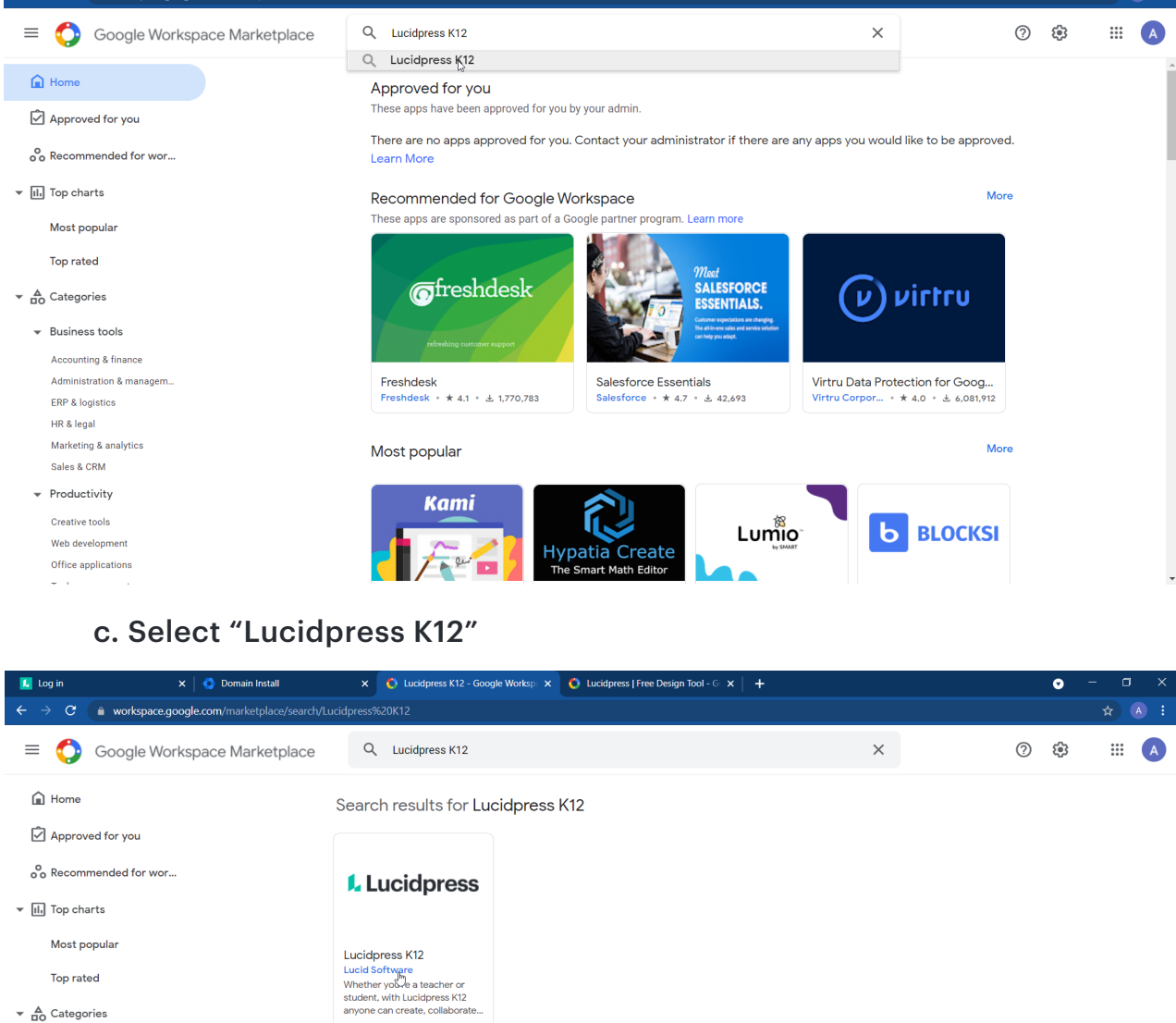

Step 2: Install the new Lucidpress K12 app.

a. From the Workspace Marketplace Apps page in the Admin Console, select “Add App to Domain Install List”

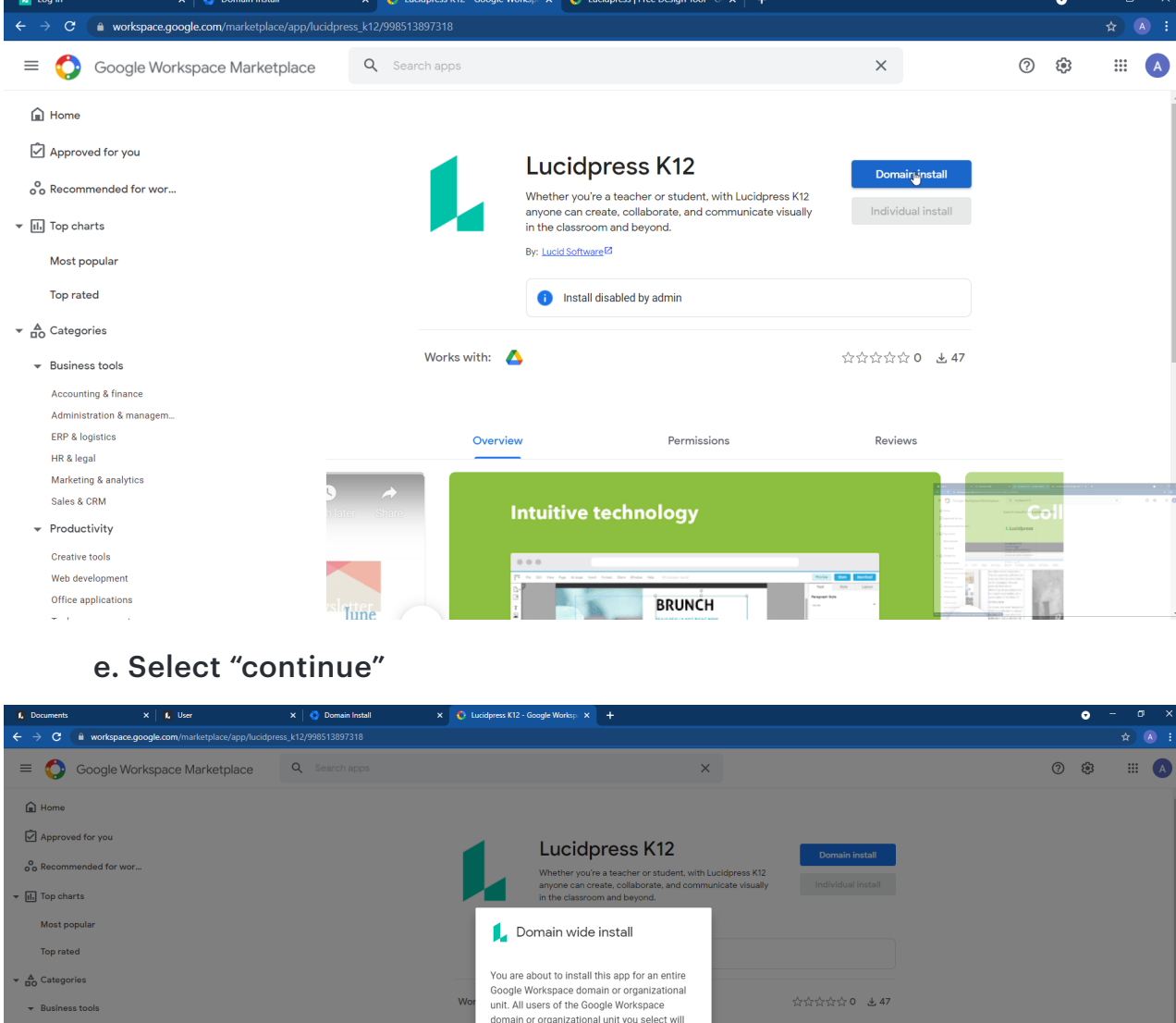

b. Search for “Lucidpress K12”

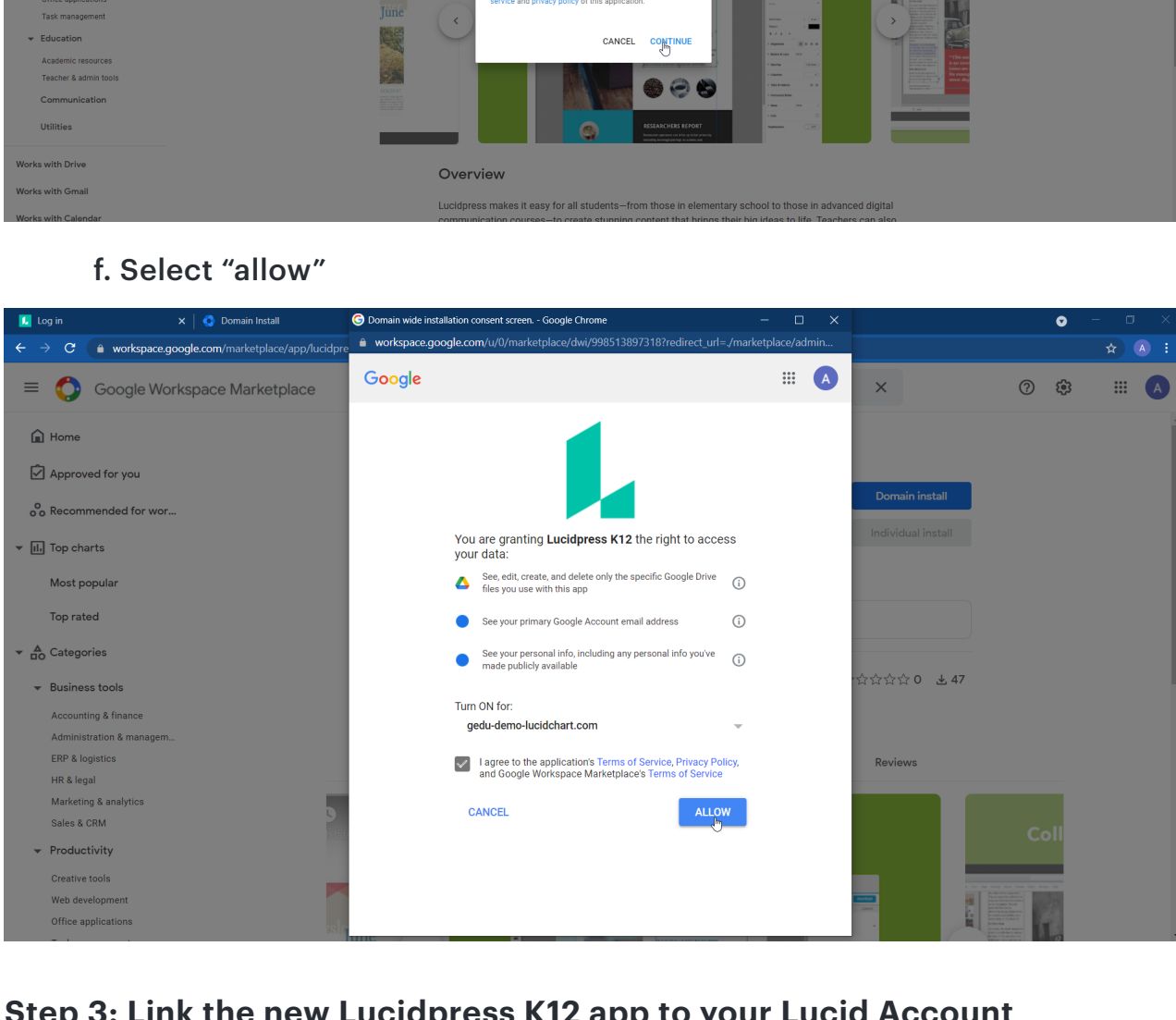

c. Select “Install” and follow modal. Select “Domain Install.”

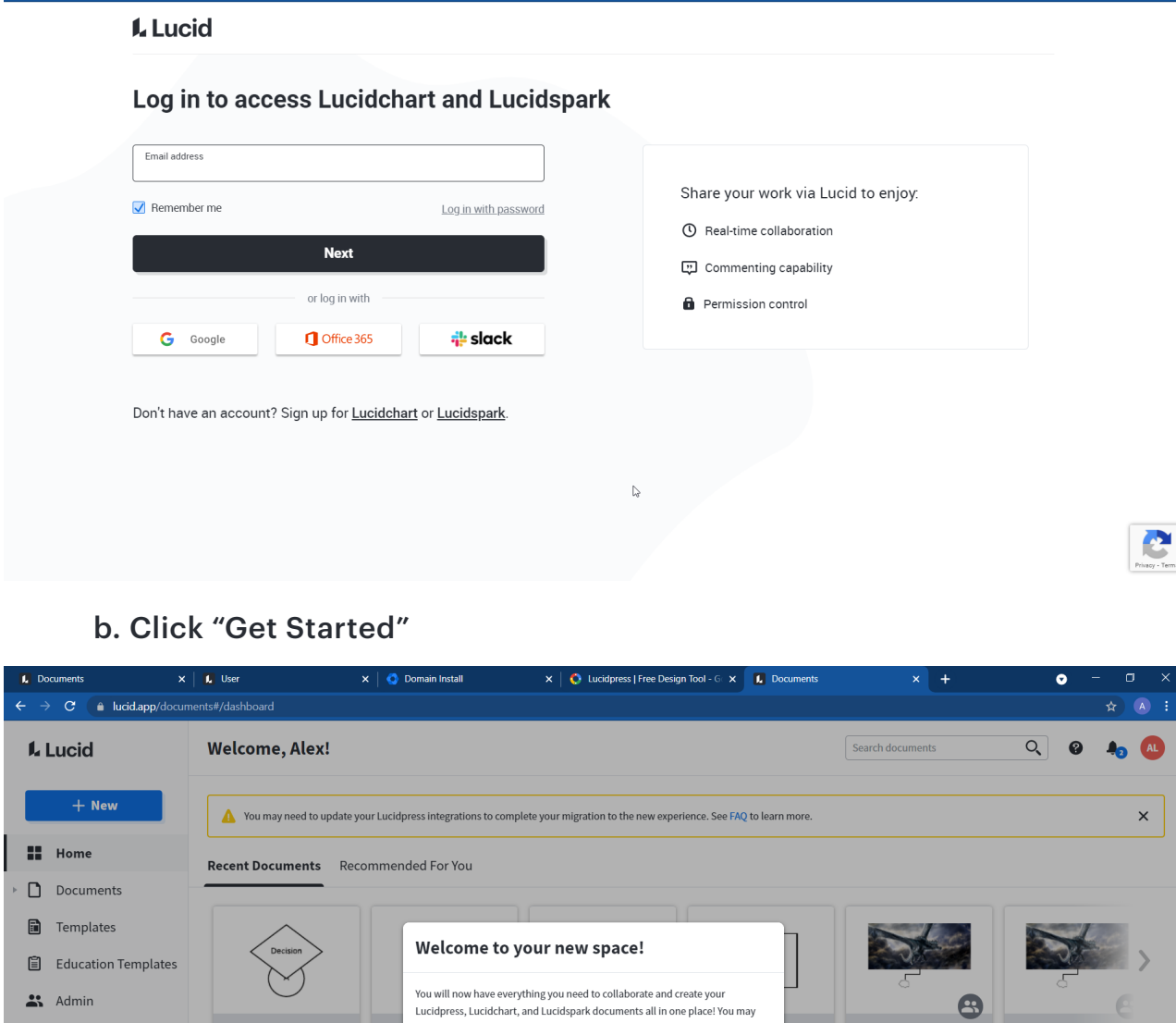

d. Select “continue”

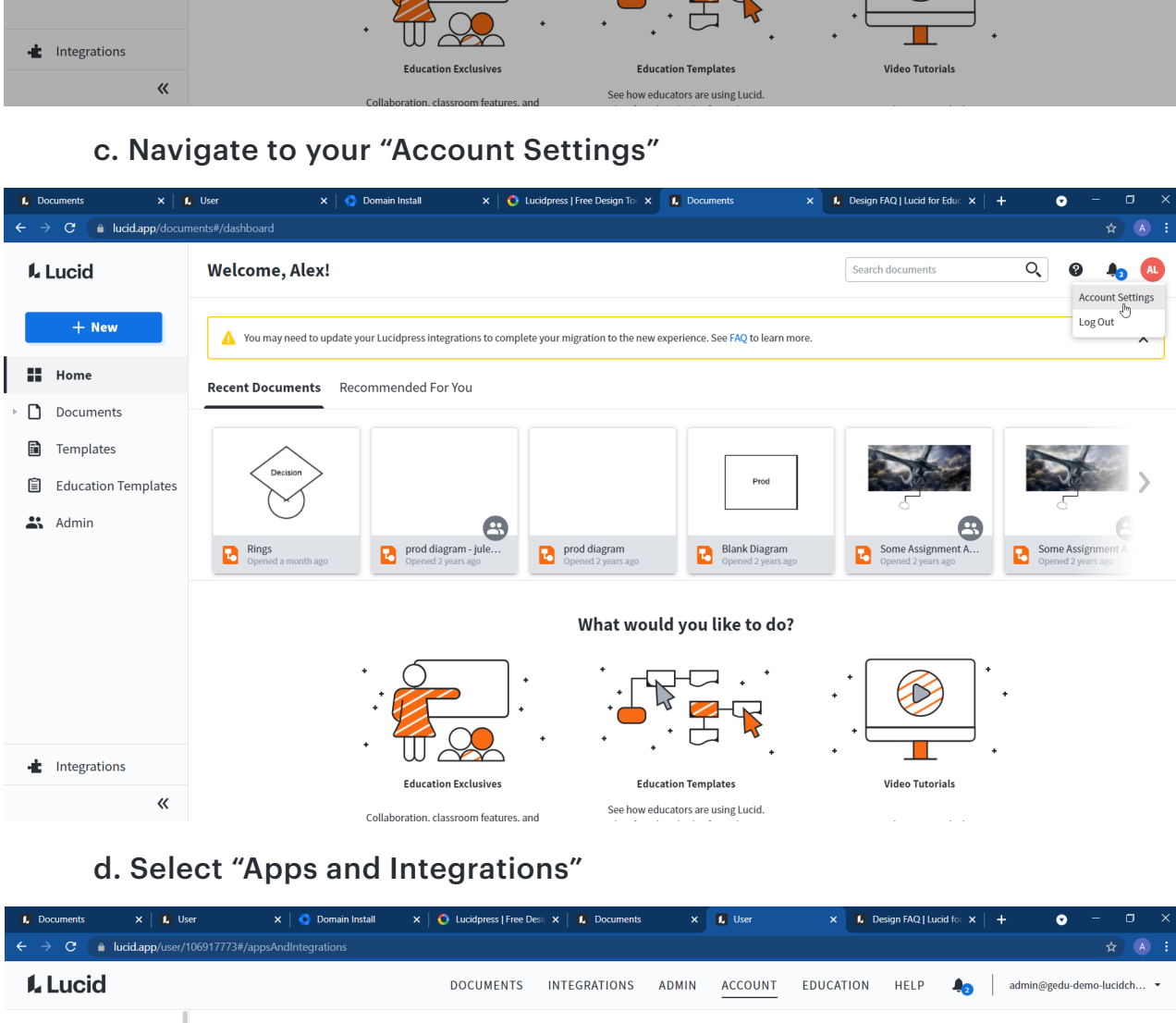

e. Select “allow”

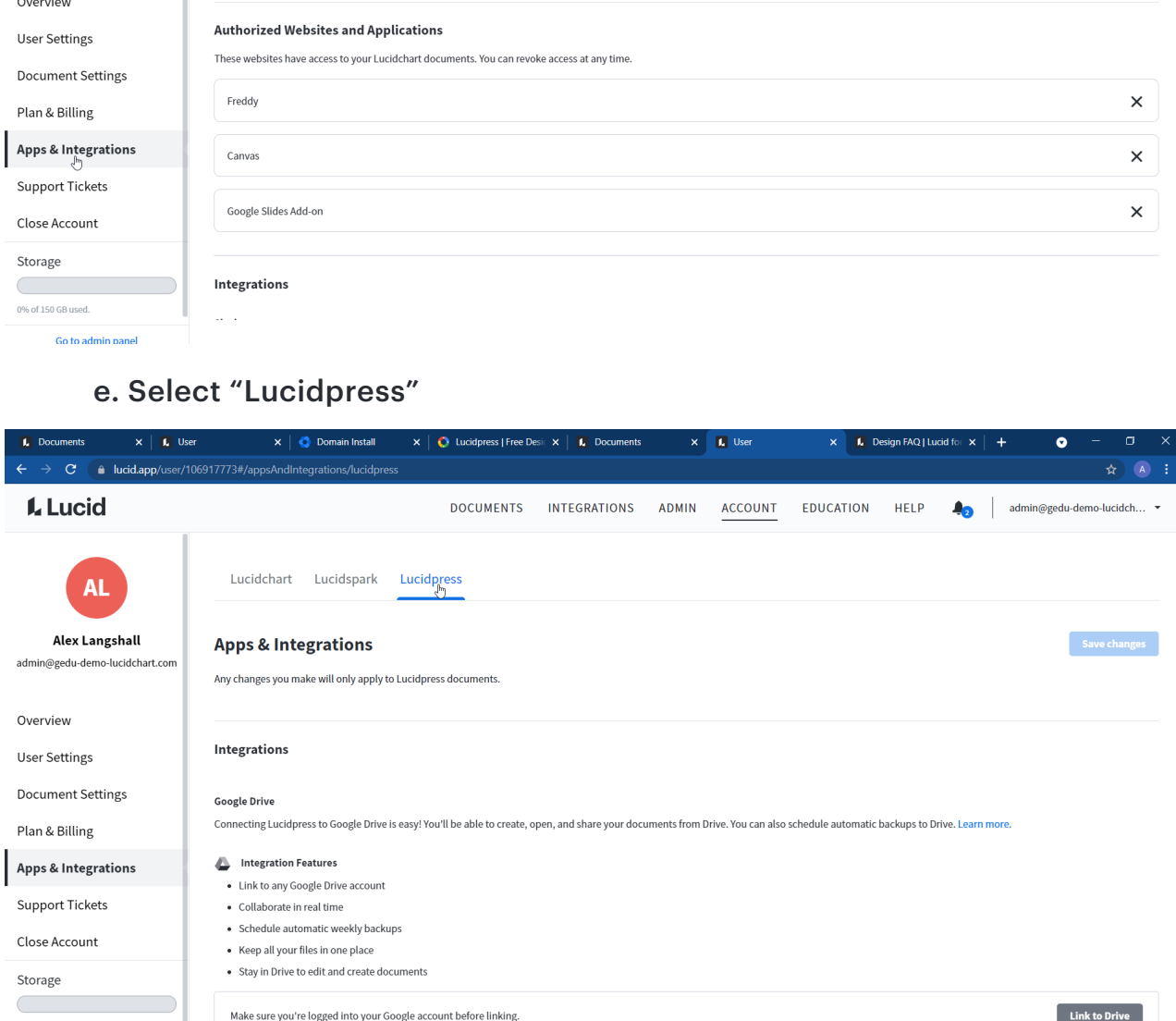

Step 3: Link the new Lucidpress K12 app to your Lucid Account

a. Sign in to Lucid

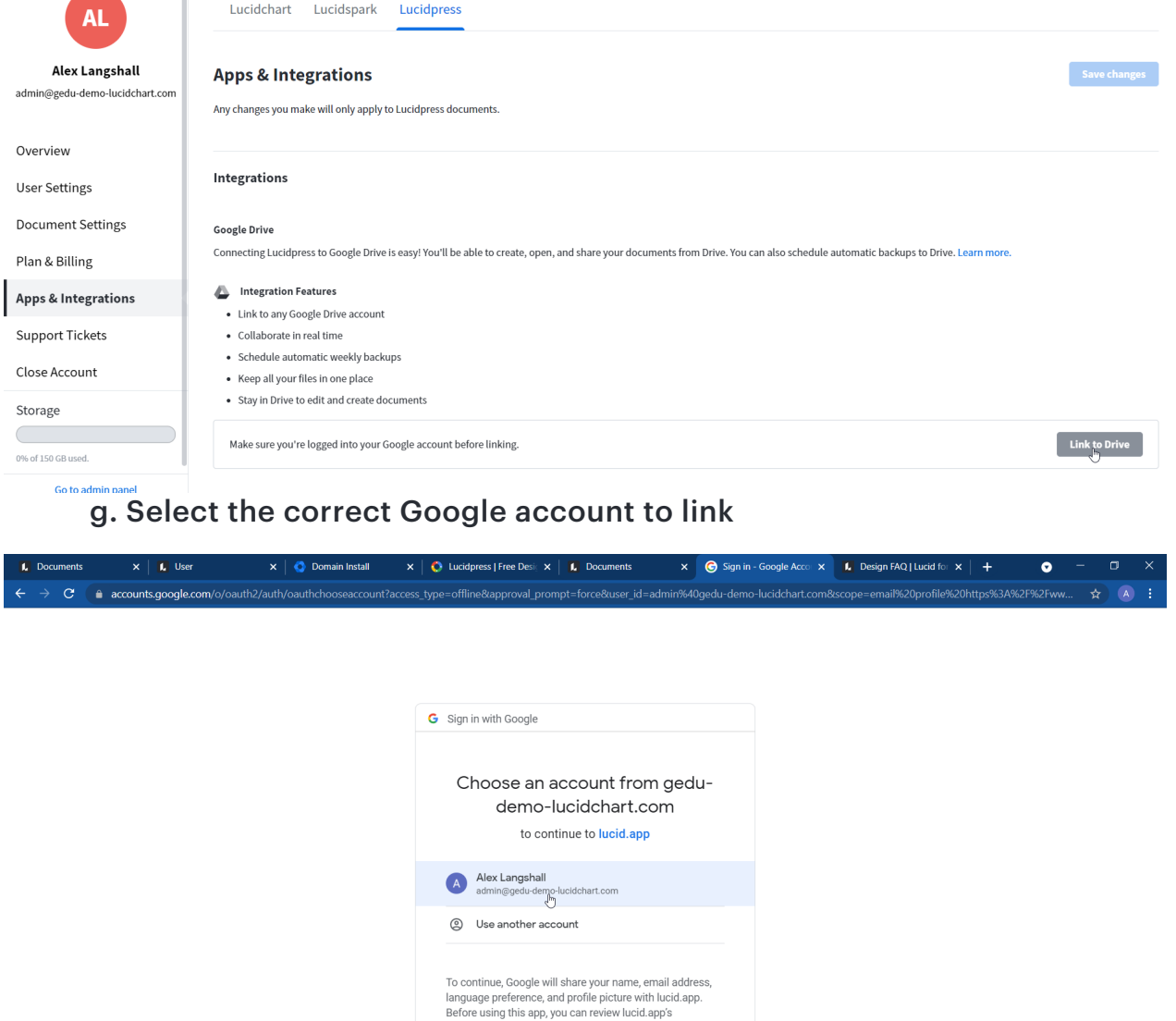

b. Click “Get Started”

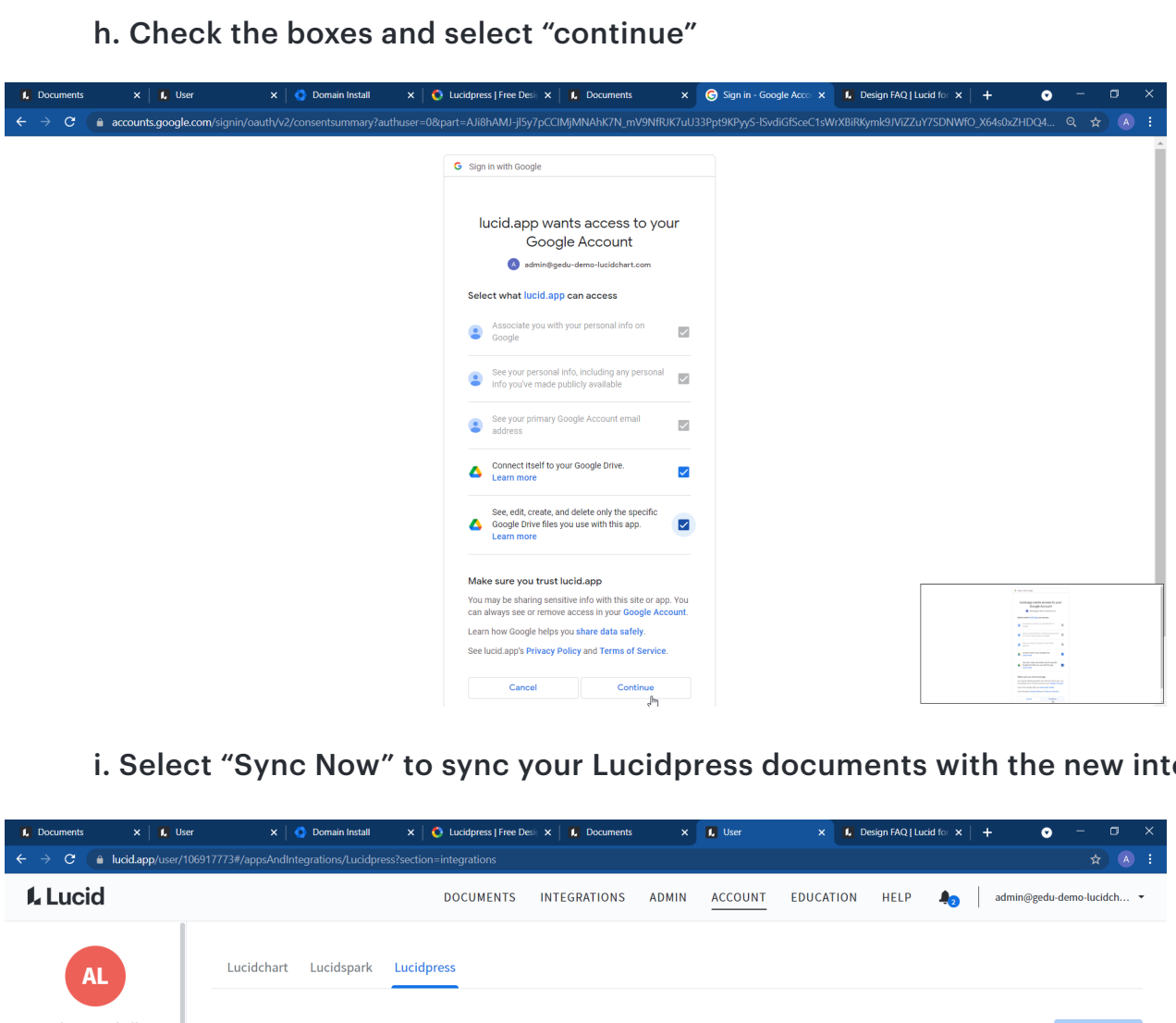

c. Navigate to your “Account Settings”

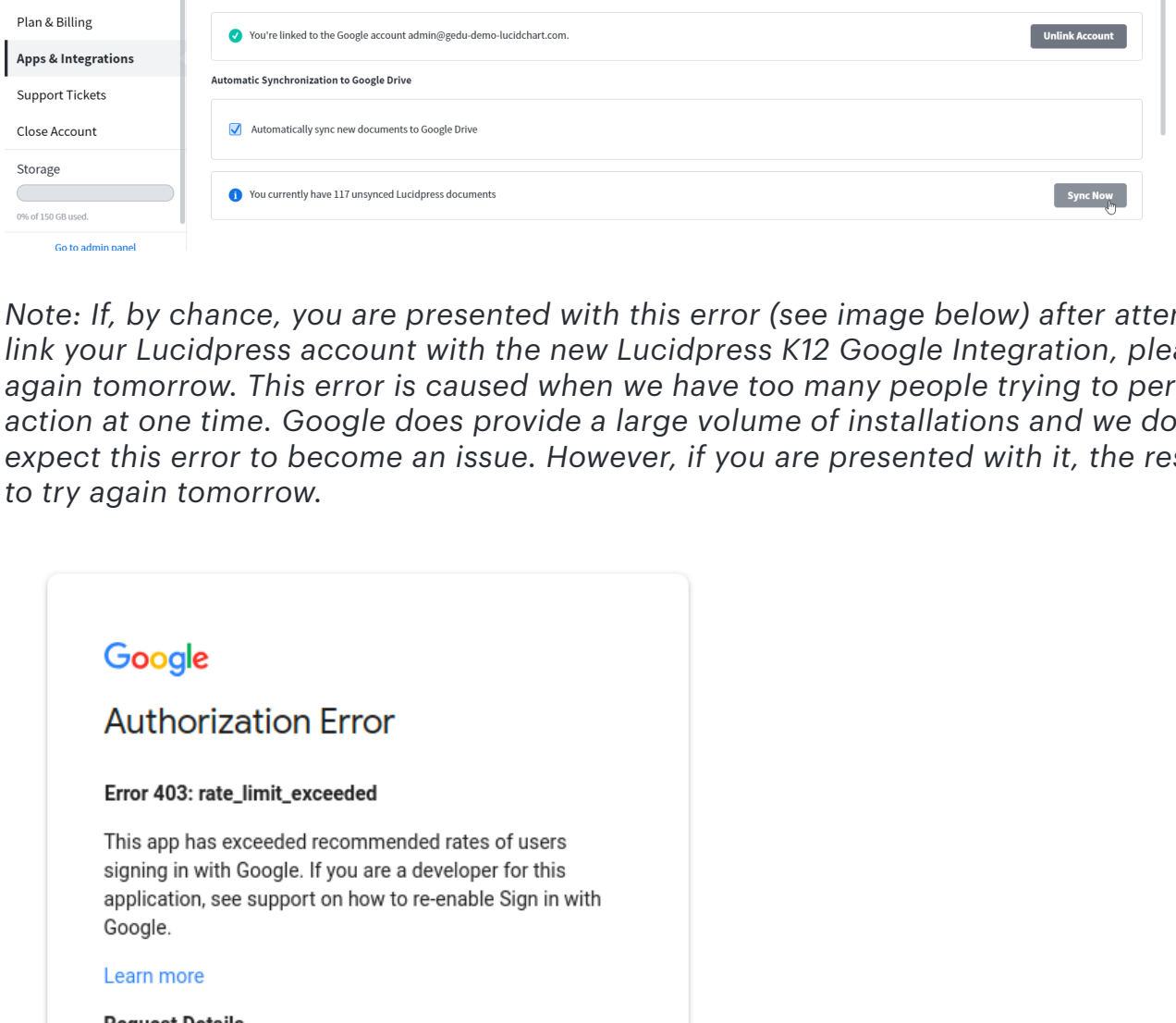

d. Select “Apps and Integrations”

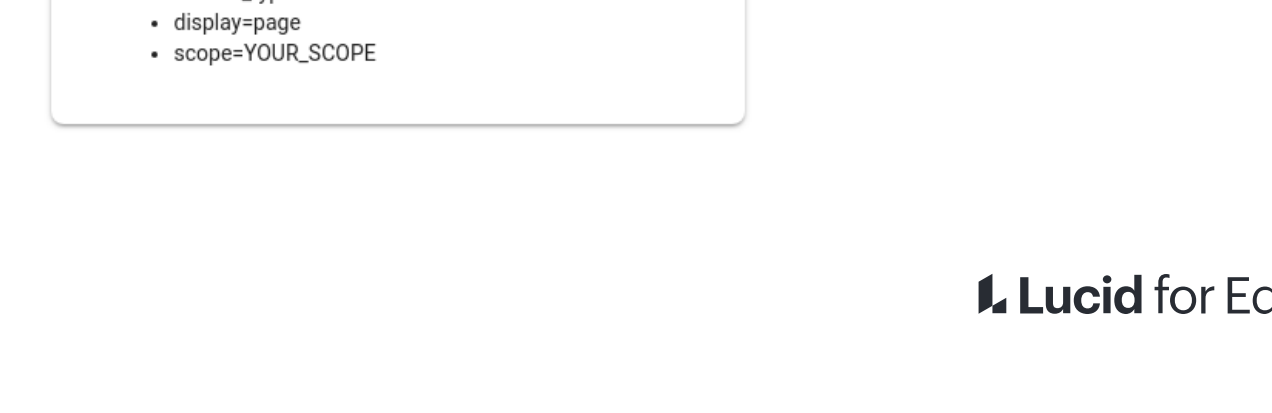

e. Select “Lucidpress”

f. Select “Link to Drive”

g. Select the correct Google account to link

h. Check the boxes and select “continue”

i. Select “Sync Now” to sync your Lucidpress documents with the new integration

Note: If, by chance, you are presented with this error (see image below) after attempting to link your Lucidpress account with the new Lucidpress K12 Google Integration, please try again tomorrow. This error is caused when we have too many people trying to perform this action at one time. Google does provide a large volume of installations and we do not expect this error to become an issue. However, if you are presented with it, the resolution is to try again tomorrow.

Authorization Error

Error 403: rate_limit_exceeded

This app has exceeded recommended rates of users signing in with Google. If you are a developer for this application, see support on how to re-enable Sign in with Google.

[Learn more](#)

Request Details

- redirect_uri=YOUR_REDIRECT_URI
- prompt=consent
- response_type=code
- client_id=YOUR_CLIENT_ID
- access_type=offline
- displaypage
- scope=YOUR_SCOPE